

Technical sheet No 70GM/KAR

1. Supplier name: **GÓRALMET Sp. z o.o.**

Supplier address: **ul. Krakowska 68, 32-860 Czchów, tel/fax 014 6635260**

2. Product name: **Grade 10 lifting chain**

3. Description and use: Grade 10 medium precision short link chains – 1000 N/ mm² (MPa), for slings and lifting purposes. For use within technical parameters given in point 5 and the Directive 2006/42/EC

4. Working load limits are given for the normal working conditions. Usage in extreme conditions is not allowed without supplier agreement. Storage, installation and usage - according to instruction manual for lifting accessories.

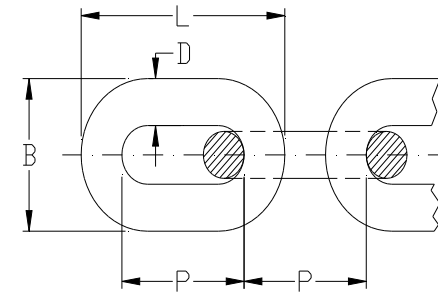

5. Technical parameters:

No	Size D [mm]	Dimensions [mm]			Weight [kg/m]	WLL Working load [t]	MPF Proof force [kN]	BF Breaking force [min. kN]	Material	Coatings	A _≥ [%]
		L [max]	P	B [max]							
1	2	3	4	5	6	7	8	9	10	11	12
1	6 ± 0,24	30,5	18 ± 0,5	22,2	0,857	1,4	34,3	54,9	Grade 10 steel: Cr ≥ 0,40 % Ni ≥ 0,40 % Mo ≥ 0,20 % Al ≥ 0,025 % S ≤ 0,025 % P ≤ 0,025 %	Galvanization and paint or paint	20
2	8 ± 0,32	40,7	24 ± 0,7	29,6	1,510	2,5	61,3	98,1			20
3	10 ± 0,4	50,9	30 ± 0,9	37	2,333	4	98,1	156,9			20
4	13 ± 0,52	66,2	39 ± 1,2	48,1	3,900	6,7	164,3	262,8			20

6. Additional informations:

- Safety factor -4,
- MPF=2,5 x g x WLL, BF =4,0 x g x WLL where g - acceleration of gravity in m/s² (i.e. 9,80665)
- Traceability code: a four-digit number by formula - YYMM (YY = year of production , MM = month of production)
- Markings (every 20-th link or every 1 meter): **10** ; **GMG** or **GM**; traceability code
- Additional informations – label and tag: **CE** ; product name ; size; certificate No; WLL(t)...; quantity; order No; manufacturer's data and website address.