

Technical sheet No 24GM/KAR

1. Supplier name: **GÓRALMET Sp. z o.o.**

Supplier address: **ul. Krakowska 68, 32-860 Czchów, tel/fax 014 6635260**

2. Product name: **Galvanized double pulley with nylon wheel**

3. Description and use: Pulley with double nylon wheels, designed for manual lifting and hanging with the use of wire ropes. For use within technical parameters given in point 5.

4. Galvanized double pulleys with nylon wheel cannot be used in the applications other than described in point no 3. Do not overload over WLL (kG) given in column 13.

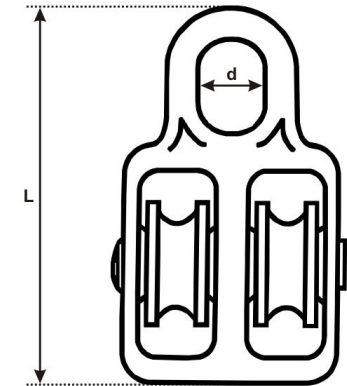

5. Technical parameters:

No	Size [mm]	Nominal dimensions [mm]									Weight [kg/pc]	WLL Working load [kG]	BF Breaking force [min. kG]	Material	Coatings
		d [mm]	L [mm]	For rope max [mm]	---	---	---	---	---	---					
1	2	3	4	5	6	7	8	9	10	11	12	13	14	15	16
1	15	9,5	50	6	---	---	---	---	---	---	0,036	150	450	Body: ZnAl4 Wheels: nylon	Electro-galvanized
2	20	10,5	60	7	---	---	---	---	---	---	0,056	200	600		
3	25	11	70	7	---	---	---	---	---	---	0,089	210	630		
4	30	12,5	80	8	---	---	---	---	---	---	0,142	250	750		
5	40	15	93	10	---	---	---	---	---	---	0,211	300	900		
6	50	16	113	12	---	---	---	---	---	---	0,326	330	990		

6. Additional informations:

- Safety factor - 3
- BF = 3,0 x WLL
- Markings size code
- Additional informations – label: product name; size; quantity; order No; manufacturer's data and website address.