

Technical sheet No 144GM/KAR

1. Supplier name: **GÓRALMET Sp. z o.o.**

Supplier address: **ul. Krakowska 68, 32-860 Czchów, tel/fax 014 6635260**

2. Product name: **Dee shackle INOX316**

3. Description and use: Acid-proof stainless steel dee shackle with screwed pin with eye and collar, for use as connecting elements in rope ends, chains, and the other general applications. For use within technical parameters given in point 5.

4. Dee shackles INOX316 cannot be used in the applications that has safety requirements regulated by law or standards, for example for lifting. Do not overload over WLL (kG) given in column 13.

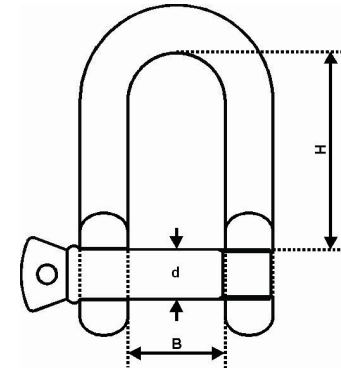

5. Technical parameters:

No	Size [mm]	Nominal dimensions [mm]									Weight [kg/pc]	WLL Working load [kG]	BF Breaking force [min. kG]	Material	Coatings
		d [mm]	B [mm]	H [mm]	---	---	---	---	---	---					
1	2	3	4	5	6	7	8	9	10	11	12	13	14	15	16
1	5	4,8	10,5	20	---	---	---	---	---	---	0,020	375	1500	AISI316	---
2	6	5,8	12,5	24	---	---	---	---	---	---	0,023	475	1900		
3	8	7,8	16	33	---	---	---	---	---	---	0,059	900	3600		
4	10	9,8	20	40	---	---	---	---	---	---	0,114	1225	4900		
5	12	11,9	24	49	---	---	---	---	---	---	0,200	2100	8400		
6	14	13,6	29	55	---	---	---	---	---	---	0,313	2250	9000		

6. Additional informations:

- Safety factor - 4
- BF =4,0 x WLL
- Markings: manufacturer's symbol – GMG; size code (sizes less than 6 - size code only)
- Additional informations – label: product name; size; quantity; order No; manufacturer's data and website address.