

Technical sheet No 16GM/KAR

1. Supplier name: **GÓRALMET Sp. z o.o.**

Supplier address: **ul. Krakowska 68, 32-860 Czchów, tel/fax 014 6635260**

2. Product name: **Agricultural hook**

3. Description and use: Forged steel hooks with eye for use in agriculture, as chain accessory, and the other general applications. For use within technical parameters given in point 5.

4. Agricultural hooks cannot be used in the applications that has safety requirements regulated by law or standards, for example for lifting. Do not overload over WLL (kG) given in column 13.

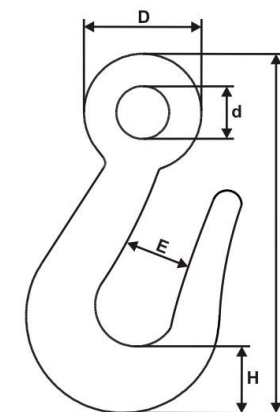

5. Technical parameters:

| No | Size [mm] | Nominal dimensions [mm] | | | | | | | | | Weight [kg/pc] | WLL Working load [kG] | BF Breaking force [min. kG] | Material | Coatings |
|----|------------|-------------------------|--------|--------|--------|--------|-----|-----|-----|-----|----------------|-----------------------|-----------------------------|----------|--------------------|
| | | d [mm] | D [mm] | h [mm] | H [mm] | E [mm] | --- | --- | --- | --- | | | | | |
| 1 | 2 | 3 | 4 | 5 | 6 | 7 | 8 | 9 | 10 | 11 | 12 | 13 | 14 | 15 | 16 |
| 1 | 50 | 8,5 | 20 | 55,5 | 10 | 13 | --- | --- | --- | --- | 0,035 | 140 | 420 | C15 | Electro-galvanized |
| 2 | 60 | 8,7 | 23,5 | 70 | 14 | 14,7 | --- | --- | --- | --- | 0,060 | 180 | 540 | | |
| 3 | 70 | 10,6 | 26 | 81 | 16 | 12,9 | --- | --- | --- | --- | 0,105 | 280 | 840 | | |
| 4 | 80 | 10,6 | 28 | 89 | 17 | 16,8 | --- | --- | --- | --- | 0,137 | 350 | 1050 | | |
| 5 | 90 | 12,3 | 30 | 101 | 17 | 18,2 | --- | --- | --- | --- | 0,200 | 440 | 1320 | | |
| 6 | 100 | 12,1 | 33 | 113 | 21,5 | 18,4 | --- | --- | --- | --- | 0,260 | 480 | 1440 | | |
| 7 | 120 | 15,5 | 37 | 116,5 | 21,8 | 17,7 | --- | --- | --- | --- | 0,337 | 660 | 1980 | | |

6. Additional informations:

- Safety factor - 3
- BF = 3,0 x WLL
- Markings: manufacturer's symbol – GM or GMG; size code
- Additional informations – label: product name; size; quantity; order No; manufacturer's data and website address.