

## Technical sheet No 18GM/KAR

1. Supplier name: **GÓRALMET Sp. z o.o.**

Supplier address: **ul. Krakowska 68, 32-860 Czchów, tel/fax 014 6635260**

2. Product name: **Grade 8 lifting chain EN818-2**

3. Description and use: Grade 8 medium precision short link chains – 800 N/ mm<sup>2</sup> (MPa), for slings and lifting purposes. For use within technical parameters given in point 5 and the Directive 2006/42/EC

4. Working load limits are given for the normal working conditions. Usage in extreme conditions is not allowed without supplier agreement. Storage, installation and usage - according to instruction manual for lifting accessories.

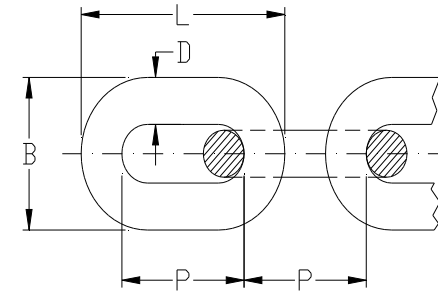

5. Technical parameters:

No	Size D [mm]	Dimensions [mm]			Weight [kg/m]	WLL Working load [t]	MPF Proof force [kN]	BF Breaking force [min. kN]	Material	Coatings	A <sub>≥</sub> [%]
		L [max]	P	B [max]							
1	2	3	4	5	6	7	8	9	10	11	12
1	6 ± 0,24	30,5	18 ± 0,5	22,2	0,8	1,12	28,3	45,2	Grade 8 steel: Cr ≥ 0,40 % Ni ≥ 0,40 % Al ≥ 0,025 % S ≤ 0,025 % P ≤ 0,025 %	Galvanization and paint or paint	20
2	7 ± 0,28	36,1	21 ± 0,6	25,9	1,1	1,5	38,5	61,6			20
3	8 ± 0,32	40,7	24 ± 0,7	29,6	1,4	2	50,3	80,4			20
4	10 ± 0,4	50,9	30 ± 0,9	37	2,2	3,15	78,5	126			20
5	13 ± 0,52	66,2	39 ± 1,2	48,1	3,8	5,3	133	212			20
6	16 ± 0,64	82,4	48 ± 1,4	59,2	5,7	8	201	322			20

6. Additional informations:

- Safety factor -4,
- MPF=2,5 x g x WLL, BF =4,0 x g x WLL where g - acceleration of gravity in m/s<sup>2</sup> (i.e. 9,80665)
- Traceability code: A and a four-digit number by formula - YYMM (YY = year of production , MM = month of production)
- Markings (every 20-th link or every 1 meter): **8** ; **GMG** or **GM**; traceability code
- Additional informations – label and tag: **CE** ; product name ; size; certificate No; WLL(t)...; quantity; order No; manufacturer's data and website address.