

Technical sheet No 12GM/KAR

1. Supplier name: **GÓRALMET Sp. z o.o.**

Supplier address: **ul. Krakowska 68, 32-860 Czchów, tel/fax 014 6635260**

2. Product name: **Dee shackle**

3. Description and use: Steel dee shackle with screwed pin with eye and collar, for use as connecting elements in rope ends, chains, and the other general applications. For use within technical parameters given in point 5.

4. Dee shackles cannot be used in the applications that has safety requirements regulated by law or standards, for example for lifting. Do not overload over WLL (kG) given in column 13.

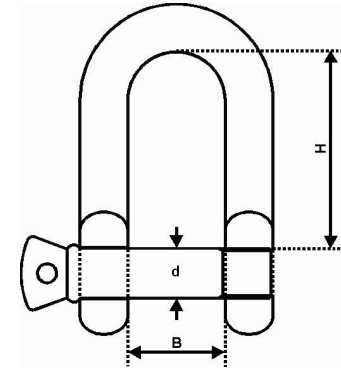

5. Technical parameters:

No	Size [mm]	Nominal dimensions [mm]									Weight [kg/pc]	WLL Working load [kG]	BF Breaking force [min. kG]	Material	Coatings
		d [mm]	B [mm]	H [mm]	---	---	---	---	---	---					
1	2	3	4	5	6	7	8	9	10	11	12	13	14	15	16
1	3,5	4	8	16	---	---	---	---	---	---	0,008	50	150	C10~C15	Electro-galvanized
2	5	5	10	20	---	---	---	---	---	---	0,015	80	240		
3	6	6	12	24	---	---	---	---	---	---	0,025	100	300		
4	8	8	16	32	---	---	---	---	---	---	0,051	200	600		
5	10	10	20	40	---	---	---	---	---	---	0,109	320	960		
6	12	12	25	48	---	---	---	---	---	---	0,206	520	1560		
7	14	14	28	56	---	---	---	---	---	---	0,325	650	1950		
8	16	16	32	63	---	---	---	---	---	---	0,487	800	2400		
9	18	18	36	71	---	---	---	---	---	---	0,708	1000	3000		
10	20	20	38	76	---	---	---	---	---	---	0,912	1100	3300		
11	22	22	44	82	---	---	---	---	---	---	1,285	1500	4500		
12	25	25	50	95	---	---	---	---	---	---	1,850	2100	6300		
13	28	28	56	106	---	---	---	---	---	---	2,507	3000	9000		

6. Additional informations:

- Safety factor - 3
- $BF = 3,0 \times WLL$
- Markings: manufacturer's symbol – GM or GMG; size code; WLL....T (sizes less than 10 - manufacturer's symbol and size code only)
- Additional informations – label: product name; size; quantity; order No; manufacturer's data and website address.